

copyright 1998 Ozaukee County Historical Society

FLAT MAP OF CEDARBURG - 1939

Township 10 North, Range 21 East
at the Fourth Principal Meridian
Ozaukee County, Wisconsin

- 1 A Bernice, Roper.
- 2 A Arneberg, Edw.
- 3 A Becker's Creamery
- 4 A Maple, Emma
- 5 A Kramer, Arthur
- 6 A Thomas, Arthur
- 7 A Gohres, John
- 8 A Frank, Erwin
- 9 A Bergsch, Richer
- 10 A Gaster, Mirv
- 11 A Gaster, Arthur
- 12 A Gaster, John
- 13 A Fox Farms
- 14 A Schellberg, Est
- 15 A Mueller, E.
- 16 A Coopman, A.
- 17 A Mueller, Wm.
- 18 A Five Corners
- 19 A Clausen, Fred
- 20 A Zitzeloff, Morv
- 21 A Topp, Hub
- 22 A Topp, Fred
- 23 A Wolfgram, Robert
- 24 A Wilhelm, Arthur
- 25 A Benner, Richard
- 26 A Log Luth, Chris
- 27 A Salko, John
- 28 A Schneider, Chas
- 29 A Arny, August
- 30 A Riedel, Wm
- 31 A Groch, Ferd
- 32 A Kueker, Carl
- 33 A Mielke, Edw
- 34 A Sudarik, Theo
- 35 A Jaeger, Emma
- 36 A Kasten, Wm
- 37 A Poppold, Est
- 38 A From, Nic
- 39 A Wills, Peter
- 40 A Grosser, Wm
- 41 A Marone, August
- 42 A Krueger, Fritz
- 43 A Krueger, August
- 44 A Krueger, Gustav
- 45 A Wacker, John
- 46 A Anshutz, Ch
- 47 A Dues, Peter
- 48 A Jaeger, Emma
- 49 A Schuber, Mary
- 50 A Poole, Wm.
- 51 A Moser, Arthur
- 52 A Brachme, Lydia
- 53 A Freeman, Fred
- 54 A Hradsky, Wm
- 55 A Cresson, Al
- 56 A Schanen, Wm
- 57 A Auerbach, Selma
- 58 A Dobbner, Geo
- 59 A Reppelt, Richard
- 60 A Ziebell, Paul
- 61 A Fritze, Albert
- 62 A Kays, Wm
- 63 A Graese, Erwin
- 64 A Krasner, Walter
- 65 A Dopper, Wm
- 66 A Kasper, Wm
- 67 A Benholz, Gust
- 68 A Buch, Arthur
- 69 A Fritze, Arthur
- 70 A Schubert, Edw
- 71 A Eppman, Ann
- 72 A Trischer, John
- 73 A Groch, Lester
- 74 A Luch, Larry
- 75 A Jaeger, Otto
- 76 A Cedarburg Mill
- 77 A Buch, Arthur
- 78 A Scherer, Art
- 79 A Barck, Erwin
- 80 A Van Langet, Lm
- 81 A Kitcher, Frank
- 82 A Cass, Stepha
- 83 A Benning, L.
- 84 A Baker, Clarence
- 85 A Schultz, Bern
- 86 A Ludwig, August
- 87 A Gilow, Mrs.
- 88 A Kastele, Ar
- 89 A Sime, John
- 90 A Schultz, Robert
- 91 A Lindner, Herman
- 92 A Hill, Mrs. Geo
- 93 A Schultz, Bern
- 94 A Bannister, Ar
- 95 A Krahnke, Wm
- 96 A Kraemer, Art
- 97 A Gutlich, Wm
- 98 A Gutlich, Paul
- 99 A Benning, L.
- 100 A Baker, Clarence
- 101 A Schultz, Bern
- 102 A Ludwig, August
- 103 A Gilow, Mrs.
- 104 A Kastele, Ar
- 105 A Sime, John
- 106 A Schultz, Robert
- 107 A Lindner, Herman
- 108 A Hill, Mrs. Geo
- 109 A Schultz, Bern
- 110 A Bannister, Ar
- 111 A Krahnke, Wm
- 112 A Kraemer, Art
- 113 A Gutlich, Wm
- 114 A Gutlich, Paul

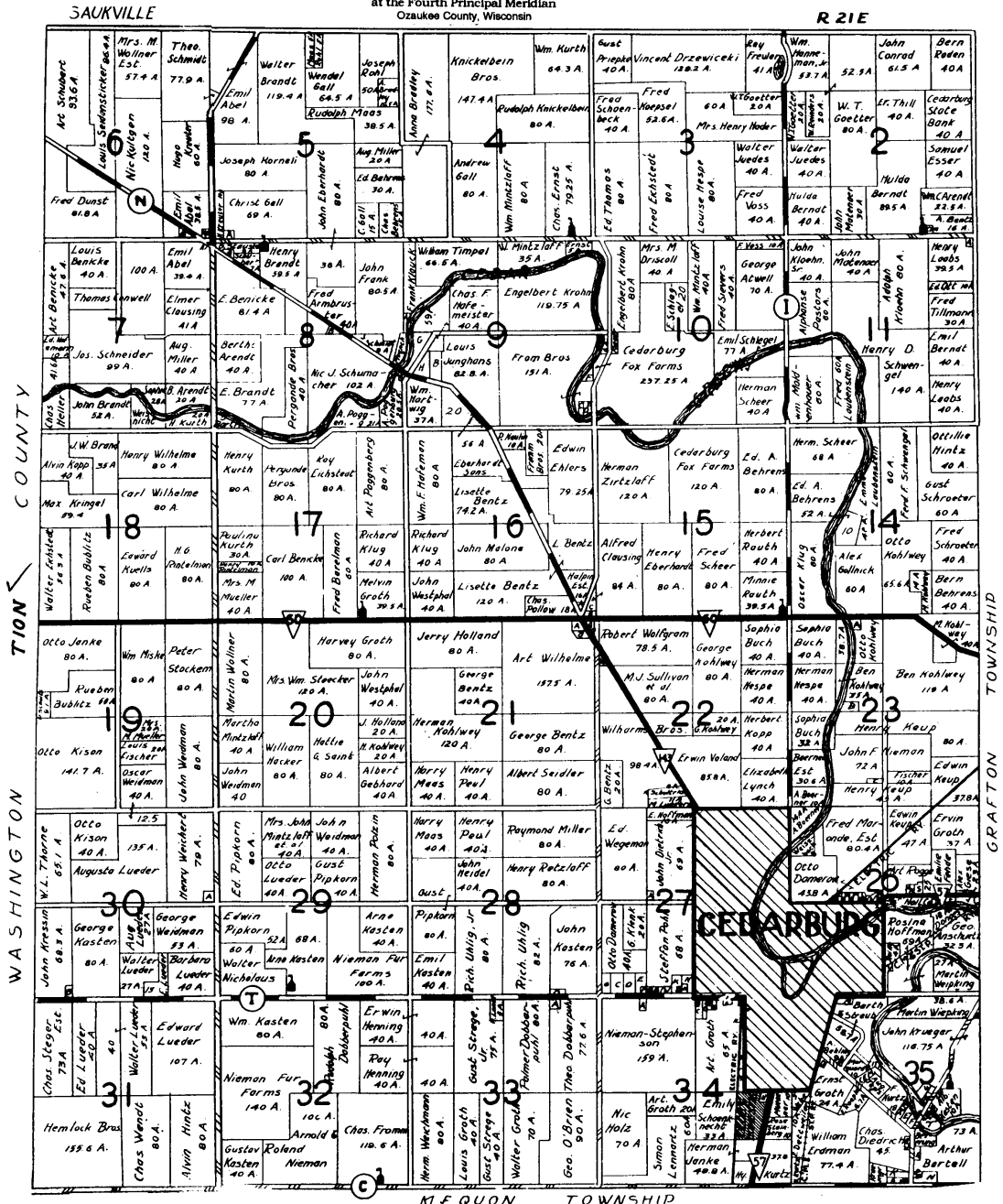

LEGEND

- HIGHWAYS
- FEDERAL
- STATE TRUNK
- COUNTY TRUNK
- COUNTY AID
- TOWN ROADS
- SCHOOLS

KIEQUON TOWNSHIP